

- DRAWING LEGEND:**
- PROPOSED 225mmØ STORM DRAINAGE
 - EXISTING STORM DRAINAGE
 - EXISTING STORM DRAINAGE TO BE DECOMMISSIONED
 - PROPOSED HIGH LEVEL PERCOLATION DRAINAGE
 - PROPOSED LAND DRAIN / UNDERDRAIN
 - PROPOSED STORM GULLY
 - DENOTES PROPOSED SOAK PIT
 - DENOTES PROPOSED WATER BUTT
 - DENOTES DIFFUSER BOX
 - DENOTES RAIN PLANTER

BIO DETENTION AREA
TOP OF BANK LEVEL 60.750
BASE LEVEL 59.030
TYP WATER LEVEL 59.130
45M3 TOTAL STORAGE VOLUME
PLANTING TO LANDSCAPE ARCH / PARKS DEPARTMENT DETAILS

BIO DETENTION AREA
TOP OF BANK LEVEL 60.800
BASE LEVEL 59.080
TYP WATER LEVEL 59.180
45M3 TOTAL STORAGE VOLUME
PLANTING TO LANDSCAPE ARCH / PARKS DEPARTMENT DETAILS

NEW STORM MANHOLE S2.1 CONSTRUCTED ON EXISTING Ø375 STORM DRAIN
CL:61.00
IL:58.400
(LEVELS TO BE CONFIRMED)
PROPOSED CONNECTION LEVEL 58.950

TYP. MANHOLE TO LAND DRAIN / UNDERDRAIN 1.425M CL TO IL

Ø375 STORM DRAIN DIVERSION TO ACCOMMODATE NEW PROPOSED HOUSING UNITS

NEW STORM MANHOLE CONSTRUCTED ON EXISTING Ø375 STORM DRAIN
CL:61.00
IL:58.22
(LEVELS TO BE CONFIRMED)
PROPOSED CONNECTION LEVEL 58.37

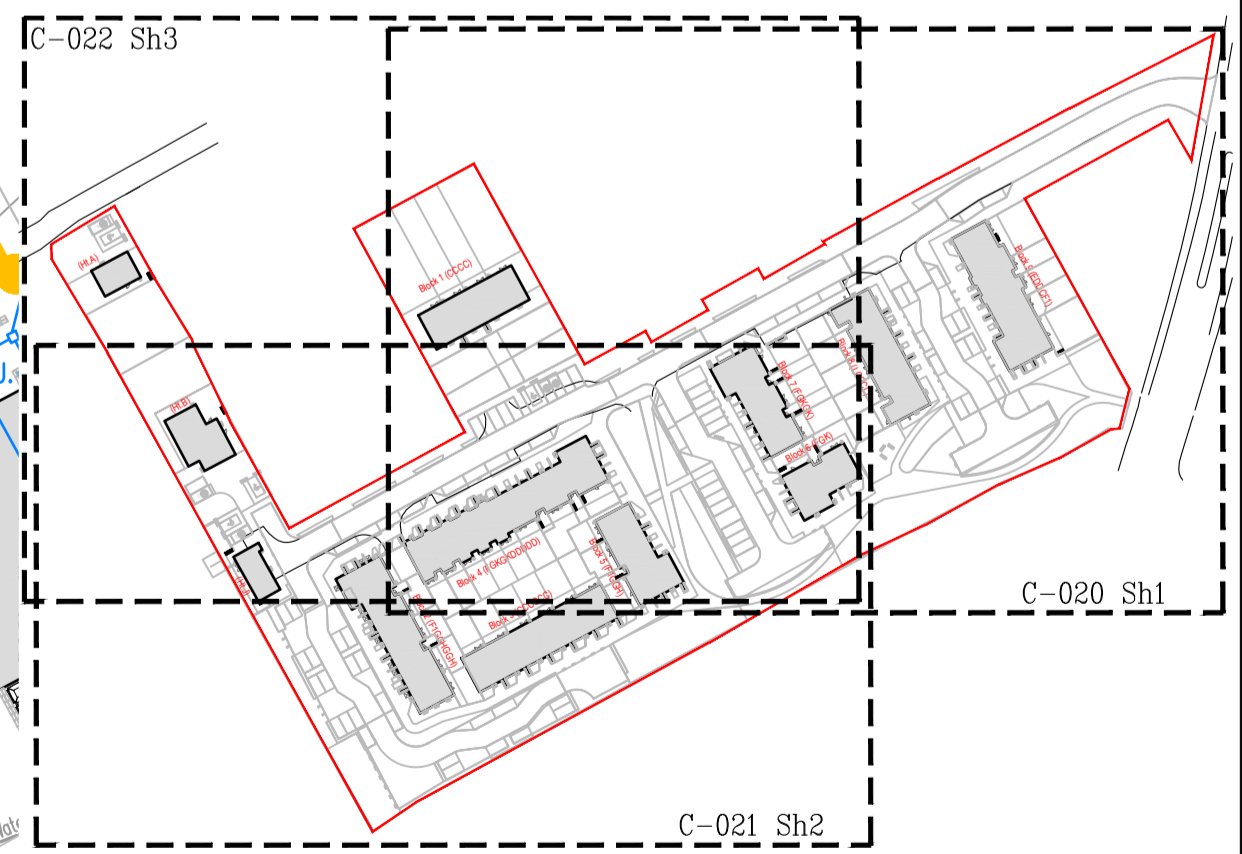

KEY PLAN
N.T.S.

© HAYES HIGGINS PARTNERSHIP

Referenced drawings	
Dwg No.	Dwg Title

Issue register				
Rev.	Date	Description	Drawn	Checked
PL1	08.04.22	PART 8		

NOTES:

- THIS DRAWING TO BE READ IN CONJUNCTION WITH ALL RELEVANT ARCHITECTS, SERVICE ENGINEERS DRAWINGS & SPECIFICATIONS.
- ALL LEVELS ARE STRUCTURAL UNLESS NOTED OTHERWISE.
- ALL WORKS TO BE CARRIED OUT IN ACCORDANCE WITH THE RELEVANT BUILDING REGULATIONS.
- DO NOT SCALE - WORK TO FIGURE DIMENSIONS ONLY.



NATURAL BASE SOLUTIONS SH3 OF SH3

Date: 02.12.21
Scale: A1 - 1:250, A3 - 1:500

Drawn By: E.HOARE
Checked By: M.CARR
Approved By: N.PATTERSON

Client: KILDARE CO. CO.

Job Description: HOUSING DEVELOPMENT AT GREENSFIELDS, MAYNOOTH, Co. KILDARE

Project No: 21KK001
Drawing Ref: C-022
Rev: PL1

PART 8

Hayes Higgins Partnership
Gas House Lane, Kilkenny.

Hayes Higgins Partnership
(056) 7742110 (056) 7723233
info@hhp.ie
www.hayeshiggins.ie

COPY: 21KK001-C020 Natural Base Solutions.dwg